

Frame-type Counting Sensor

FGQ Series



Product Features

- Detection area: 50*50mm or 120*120mm (optional)
- Response time: 80 us
- Minimum detectable object: Irregular object with a diameter of $\phi 0.3$ mm
- Output mode: NPN, PNP
- Light source: infrared light (940nm)

Application Scenario



Electronic Interface Counting



Counting Of Irregularly Shaped Workpieces



Artisan Craft Counting

Specifications And Parameters

Model	NPN	FGQ-50N-X	FGQ-120N-X
	PNP	FGQ-50P-X	FGQ-120P-X
Detection area		50*50mm	120*120mm
Minimum detection size		$\phi 0.3$ mm	$\phi 2$ mm
Light source type		Infrared light 940nm	
Response time		80us	
Power supply voltage		12-24VDC	
Output selection		Single count, cumulative count	
Sensitivity setting		Button adjustment	
Delay		0-9999ms	
Consumption current		≤ 20 mA	
Load current		≤ 100 mA	
Voltage drop		≤ 2 V	
Protection circuit		Short-circuit protection, Polarity protection, Overload protection	
Anti-ambient light		sunlight $\leq 20,000$ Lux; incandescent light 3,000 Lux	
Ambient temperature		-10°C ~ 55°C (No condensation, no icing)	
Ambient humidity		35~85%RH	
Vibration resistance		10-55Hz; Dual amplitude: 1.5mm, X, Y, Z axes are 2 hours each	
Shell material		Aluminum alloy, black anodized	
Connection method		2m PVC lead wire	

Wiring Diagram

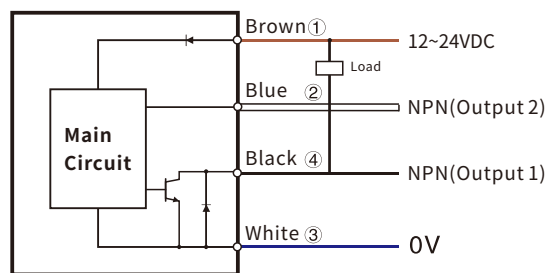

NPN Output

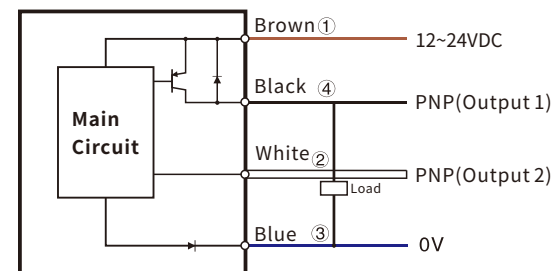

PNP Output

Note: Output 1 is For Single Count Output
Output 2 is For Cumulative Count Output

Dimensions

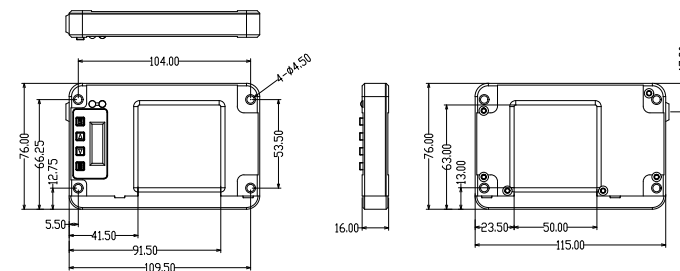

FGQ-50系列

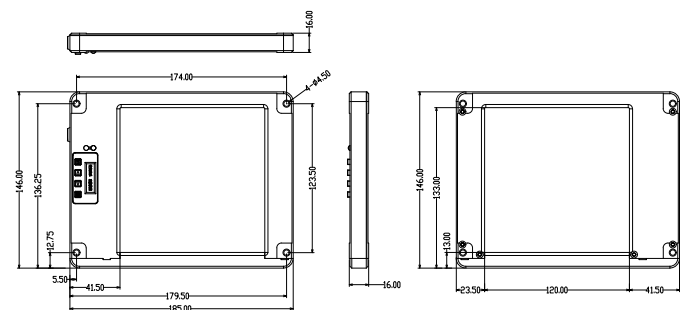

FGQ-120系列

Product Function Analysis



1.Power-on screen, use the "UP" or "DOWN" button to set the count setting

2.Press the "MODE" button briefly to enter the threshold setting.



3.Press the "MODE" button briefly again to enter the output action selection

4.Press the "UP" or "DOWN" button briefly again to select normally open (NO) or normally closed (NC)



5.Press and hold the "MODE" button to enter the light intensity mode, with adjustable settings from level 1 to 100. Use the "UP" or "DOWN" button to set the desired level

6.Press the "MODE" button briefly to enter the timing mode. Use the "UP" or "DOWN" button to sequentially select standard output, single output with delay, and output hold



7.Press the "MODE" button briefly to enter the dynamic compensation function. Use the "UP" or "DOWN" button to select on or off

8.Press and hold the "DOWN" and "MODE" buttons simultaneously to lock/unlock the buttons

Product specifications are subject to change without notice.

For more information or if you have any questions or suggestions about this product, please feel free to contact us.